

INSTALLATION GUIDE.

Please read the following installation guide carefully as the diagrams below are important for your guarantee. Improper installation will null and void your guarantee. Maintaining warranty procedures are solely the owner's responsibility.

If these steps are not followed carefully your **GUARANTEE** is **NULL** and **VOID**

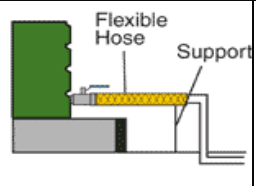
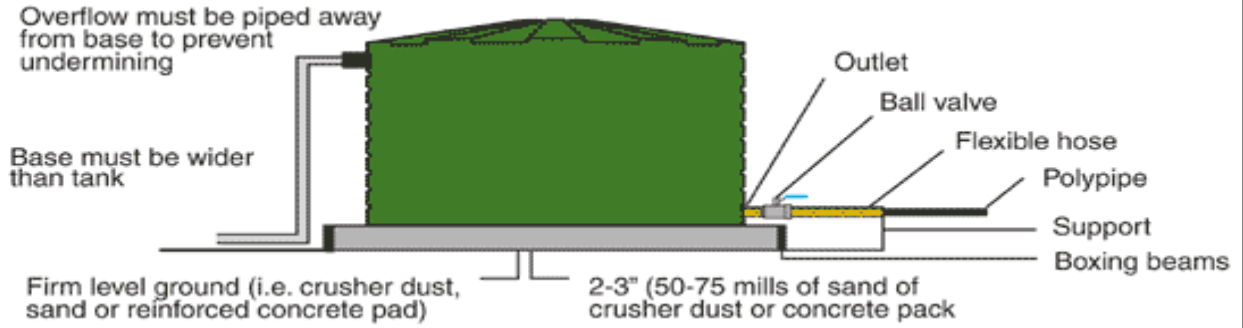

To avoid running over pipe and in turn breaking fitting, take pipe directly into ground. It must have a flexible hose fitted

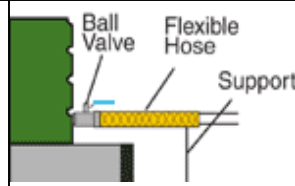

SUPPORT
Pipe must be supported. If not, this may cause water leakage and damage to the tank.
FLEXIBLE HOSE
When pipe work is exposed and over long distance, insert a length of flexible hose to absorb shocks and movement.

Below are installation problems that will void your guarantee. These are the most common, read carefully

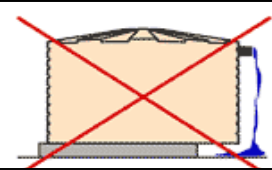

Tank base undermined - inadequate overflow length

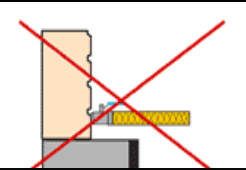

Unsupported pipe work puts excess strain on the fittings and tank wall.

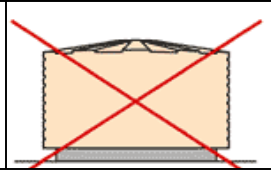

Must not have undersized base. Circumference of tank must be supported

Secure Your Tank

It is recommended that you put at least 25mm (1") of water into the tank or otherwise secure your tank from being blown away. BUSHMANS take no responsibility for tanks being damaged in this way